

MICROPET

Microphone Top Button
Side Button

Light up face
Remove face sticker
before using.



Scan for an
easy HOW TO
video:
PARENTAL CONSENT
REQUIRED BEFORE
GOING ONLINE.

Battery Door

Reset Switch

Wheels

Base Button

Battery Tab
Remove before using.



Potty
Keep for toilet function.

Packaging

LEVELS

Your Pet will call out for different needs

- "Talko"
- "Poo Poo"
- "Chargo"

Respond correctly:
It will react, then do a
celebration sound.



Respond incorrectly:
It will do a fail sound.



Play and respond correctly to its needs repeatedly to
move up levels - unlocking more personality and
responses! The higher the level, the more interactions
you'll need to advance.

BATTERIES

- If the batteries are low,
you'll see the icon on
its head flash red.



3x LR44 1.5V

BATTERIES INCLUDED.
REPLACEMENT BATTERIES NOT INCLUDED.
Replace with 3x LR44 (1.5V) batteries.

Refer to Battery Information sheet.

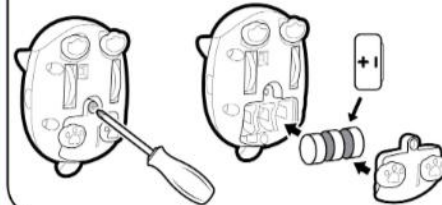

TROUBLESHOOTING

The face has stopped lighting up/it isn't making sounds:

- If you are on a high level, your Pet won't call out as often.
- If you don't respond to your Pet for a while, it will go to sleep.

Press any button to wake it up.

- Batteries may be low. Replace with fresh batteries.

I don't want to lose my Level:

- Your current level will be kept when you turn your Pet off.
- Pressing the Reset switch or changing/running out of batteries
will result in going to the bottom level.

Pet isn't responding to sound:

- Ensure you speak loud and clear when
your Pet isn't making noise/moving.
- Your Pet might be in sleep mode.
- Press any button to wake it up.

For best performance:

- Don't restrict movement of the wheels.
- I put my Pet in the Potty Case but it
isn't reacting:
- Ensure your Pet is switched on.
- Ensure your Pet is in the right orientation
in the case, and seated fully.

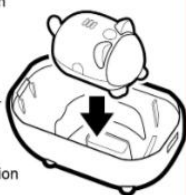

My Pet wants to go Poo Poo but I don't have the Potty:

- Hold down the Base Button on your Pet until it finishes going
to the Potty.

My Pet isn't moving:

- There might be something stuck in the wheels of the Pet.
Gently try to remove. Don't disassemble the Pet.
- Ensure you are playing on a flat, smooth surface that is indoors.

I can't connect my Pets:

- Ensure the microphones on each Pet are very close to each
other. External noise can prevent this from working.
- When connecting, make sure the Pet that you are trying to
connect to is not making noise or moving.

WARNING: NOT SUITABLE FOR CHILDREN UNDER 3 YEARS. THIS TOY PRODUCES
FLASHES THAT MAY TRIGGER EPILEPSY IN SENSITISED INDIVIDUALS.

CAUTION: OPERATE ON SMOOTH, HARD SURFACE.

IMPORTANT: READ ALL INSTRUCTIONS BEFORE USING THIS TOY. RETAIN
PACKAGING DETAILS FOR FUTURE REFERENCE. COLORS AND CONTENTS MAY VARY.
RETAIN INSTRUCTIONS FOR FUTURE REFERENCE. REMOVE ALL PACKAGING
ATTACHMENTS BEFORE GIVING THIS PRODUCT TO A CHILD.
CONTENTS: 1 ELECTRONIC TOY, 1 CASE (TOY/TOILET), 1 INSTRUCTION MANUAL,
3 LR44 BATTERIES.

FCC STATEMENT
THIS DEVICE COMPLIES WITH PART 15 OF THE FCC RULES. OPERATION IS SUBJECT TO THE FOLLOWING TWO
CONDITIONS: (1) THIS DEVICE MAY NOT CAUSE HARMFUL INTERFERENCE AND (2) THIS DEVICE MUST ACCEPT
ANY INTERFERENCE RECEIVED, INCLUDING INTERFERENCE THAT MAY CAUSE UNDESIRABLE OPERATION.
CAUTION: CHARGES OR CONDITIONS NOT EXPRESSLY APPROVED BY THE PARTY RESPONSIBLE FOR
COMPLIANCE COULD VOID THE USER'S AUTHORITY TO OPERATE THIS EQUIPMENT.
NOTE: THIS EQUIPMENT HAS BEEN TESTED AND FOUND TO COMPLY WITH THE LIMITS FOR A CLASS B DIGITAL
DEVICE. PURSUANT TO PART 15 OF THE FCC RULES, THESE LIMITS ARE DESIGNED TO PROVIDE REASONABLE
PROTECTION AGAINST HARMFUL INTERFERENCE IN A RESIDENTIAL INSTALLATION. THIS EQUIPMENT GENERATES,
USES AND CAN RADIATE RADIO FREQUENCY ENERGY AND IF NOT INSTALLED AND USED IN ACCORDANCE WITH
THESE INSTRUCTIONS, MAY CAUSE HARMFUL INTERFERENCE TO RADIO COMMUNICATIONS. HOWEVER, THERE IS
NO GUARANTEE THAT INTERFERENCE WILL NOT OCCUR IN A PARTICULAR INSTALLATION. IF THIS EQUIPMENT
DOES CAUSE HARMFUL INTERFERENCE TO RADIO OR TELEVISION RECEPTION, WHICH CAN BE DETERMINED BY
TURNING THE EQUIPMENT OFF AND ON, THE USER IS ENCOURAGED TO CORRECT THE INTERFERENCE BY
ONE OR MORE OF THE FOLLOWING MEASURES: RE-ORIENT OR RELOCATE THE RECEIVING ANTENNA; INCREASE
THE SEPARATION BETWEEN THE EQUIPMENT AND RECEIVER; CONNECT THE EQUIPMENT TO A POWER OUTLET ON A
CIRCUIT DIFFERENT FROM THAT ON WHICH THE RECEIVER IS CONNECTED; CONSULT THE DEALER OR
EXPERIENCED RADIO/TV TECHNICIAN FOR HELP. CN150308 (B) / N150308 (B)



www.moosestoy.com

© 2024 The Moose Group
© TOMY
MADE IN CHINA

micropets™
マイクロペット



Your Smart, Pocket-Sized Petbot



4+

Scan for an
easy HOW TO
video:



PARENTAL CONSENT
REQUIRED BEFORE
GOING ONLINE.